



**Sykes-Pickavant®**

# 1400 SERIES MECHANICAL PULLER RANGE



**TWIN  
LEG  
KITS**



**TRIPLE  
LEG  
KITS**



**COMBI  
LEG  
KITS**



Since 1921 Sykes-Pickavant has been manufacturing mechanical and hydraulic pullers renowned for superior quality, interchangeable components and extensive spare parts. The new 1400 Series Mechanical Puller range continues this philosophy featuring the quality and strength of components found in the Sykes-Pickavant premium 1500 Series Hydraulic Puller range.

Ideal for a wide range of automotive and industrial applications, the 1400 Series is an affordable mechanical solution, not sacrificing performance, and able to be customised and upgraded as pulling requirements change.

## DESIGN

Utilising computer-aided design (CAD) and precision machining ensures all components are interchangeable. This allows expandability and versatility to add components as your needs change, without the need to purchase complete new pullers.

Self-centring and self-locking action is achieved by the unique leg and centre nut design - gripping tighter as force is applied.

## MANUFACTURING AND TESTING

Using only high grade toughened alloy steel, legs are drop forged and heat treated for all-out performance. The unique 'I' beam x-section ensures maximum strength at the lowest mass.

Stress areas are tested using Finite Element Analysis (FEA) 3D stress simulation technologies guaranteeing optimum strength characteristics.

Fine finishing & electroplating provide an attractive premium appearance and protective final condition.



Computer-Aided Design (CAD)



Unique 'I' beam x-section

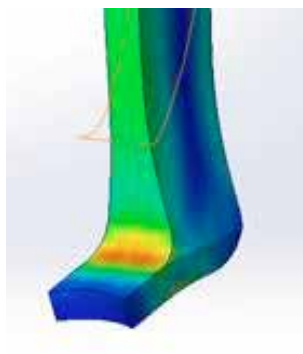

Finite Element Analysis (FEA)

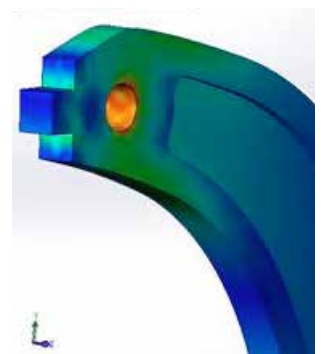

Finite Element Analysis (FEA)

# MECHANICAL PULLER RANGE



142900

## TWIN LEG KITS

Part No	Spread	Max Reach	Weight
<b>142400</b>	50 - 100mm	100mm	2.7kg
<b>142600</b>	75 - 150mm	150mm	3.2kg
<b>142800</b>	100-200mm	200mm	4kg
<b>142900</b>	130-250mm	250mm	4.75kg



143900

## TRIPLE LEG KITS

Part No	Spread	Max Reach	Weight
<b>143400</b>	50 - 100mm	100mm	2.8kg
<b>143600</b>	75 - 150mm	150mm	3.3kg
<b>143800</b>	100-200mm	200mm	4.1kg
<b>143900</b>	130-250mm	250mm	4.85kg



145003

## COMBINATION KITS

Part No	Spread	Max Reach	Weight
<b>143405</b>	50 - 100mm	100mm	3.2kg
<b>143605</b>	75 - 150mm	150mm	3.7kg
<b>143805</b>	100-200mm	200mm	5.2kg
<b>143905</b>	130-250mm	250mm	4.5kg
<b>145003</b>	50 - 150mm	150mm	5.3kg



142400

142600

142800

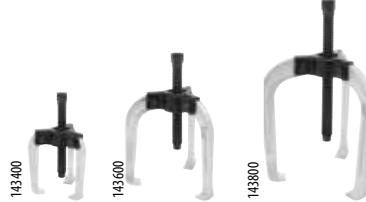

143400

143600

143800

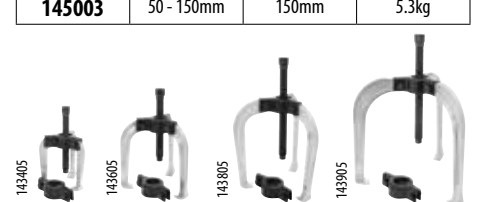

143405

143605

143805

143905

## MODULAR BY DESIGN

One 1400 Series Puller forms the basis for a highly versatile and customisable pulling system.

Add, mix and match components to suit the application.

It is no longer necessary to purchase many different pullers... One system is all you need!



Scan to download customisation chart

### REACH & SPREAD

With four leg options available reach and spread can be changed quickly and easily by adding the necessary legs to your kit. Need a bigger puller? Simply add longer legs and screw.

### TWIN OR TRIPLE LEG

Swapping between triple and twin leg pullers is as easy as changing the head.

A third leg will be required to change from twin to triple.

### MORE POWER

Converting 1400 Series Pullers to hydraulic is easy. The Hydraulic upgrade kit (1500253) will provide 8 tonnes of force with minimal effort – essentially turning the puller into a 1500 Series premium puller.

Striking force can be created via the Impact Forcing Screw add-on kit (127301). The Impact Forcing Screw has a sliding centre spindle allowing the user to strike the end once preloaded. This shocks the joint allowing easy removal of the component.

### ACCESSORIES

Keep all the 1400 Series components safe and secure for storage or transportation in the Sykes-Pickavant hand held utility tool box.

Bearing separators are available to extend the pulling applications available when used in conjunction with the 1400 Series Puller range.

#### REACH & SPREAD



142400  
Twin Puller

152929 x 2 Legs  
250mm (10")

082911  
Screw 292mm

Up to 250mm Reach  
130-250mm Spread

#### TWIN & TRIPLE LEG

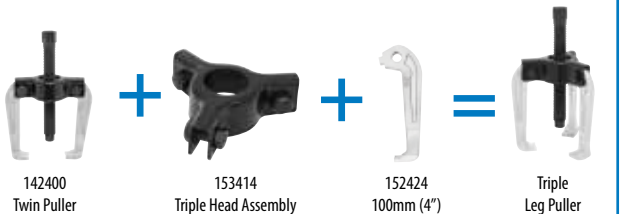

142400  
Twin Puller

153414  
Triple Head Assembly

152424  
100mm (4")

Triple  
Leg Puller

#### MORE POWER



142400  
Twin Puller

1500253  
Hydraulic Ram 8T Kit

8 Tonne  
Hydraulic Puller



## Shadow Board / Panel Kit

Includes 4, 6, 8 and 10 inch legs allowing reach up to 250mm (Max.)  
 Both twin and triple beams allow two or three leg puller configurations  
 Supplied complete with a heavy duty, powder coated backing board and vinyl overlay  
 for wall mounting in workshop or maintenance store room  
 Additional hooks and shadow provided to allow storage of Hydraulic Upgrade  
 (Part No. 1500253 sold separately)

Part No	Spread	Max Reach	No. of Puller Combinations	Weight
<b>145105</b>	50 - 250mm	250mm	8	15.14kg



## Part No: 1400SM 1400 Series Merchandiser

A sleek and efficient merchandising solution is available for in-store presentation of the 1400 Series range and features a comprehensive range of puller sets, components and hydraulic upgrade kits  
 Designed for space efficiency and practicality, the merchandiser is ideal for trade outlets, retailers and workshops  
 Each merchandiser is supplied with an information guide outlining features, benefits and upgradeable options

Part No.	Description	Qty
<b>142400</b>	Sykes 1400 Series Twin Leg Puller 4in	1
<b>142600</b>	Sykes 1400 Series Twin Leg Puller 6in	1
<b>142800</b>	Sykes 1400 Series Twin Leg Puller 8in	1
<b>1500253</b>	Sykes 1500 Ram Upgrade Kit - 1400 Series	1
<b>152413C</b>	Sykes Twin Head Assembly	1
<b>153414C</b>	Sykes Triple Head Assembly	1
<b>142414C</b>	Sykes 1400 Series Centre Nut	1
<b>082911C</b>	Sykes Forcing Screw 292mm M24x3.0	1
<b>152424C</b>	Sykes Puller Leg 100mm (4in)	3
<b>152626C</b>	Sykes Puller Leg 150mm (6in)	3
<b>152828C</b>	Sykes Puller Leg 200mm (8in)	3
<b>152929C</b>	Sykes Puller Leg 250mm (10in)	3

